

ST100 Tablet



CAUTION – Please read the full user guide including all safety warnings, before operating this product.



IN THE BOX

- ▶ Spectra Geospatial ST100 tablet with integrated batteries
- ▶ AC-DC USB-C power adapter
- ▶ USB-C to USB-A adapter
- ▶ Quick Start Guide
- ▶ EMR stylus with replacement tips and tether
- ▶ Screen protector

PARTS OF THE SPECTRA GEOSPATIAL ST100 TABLET

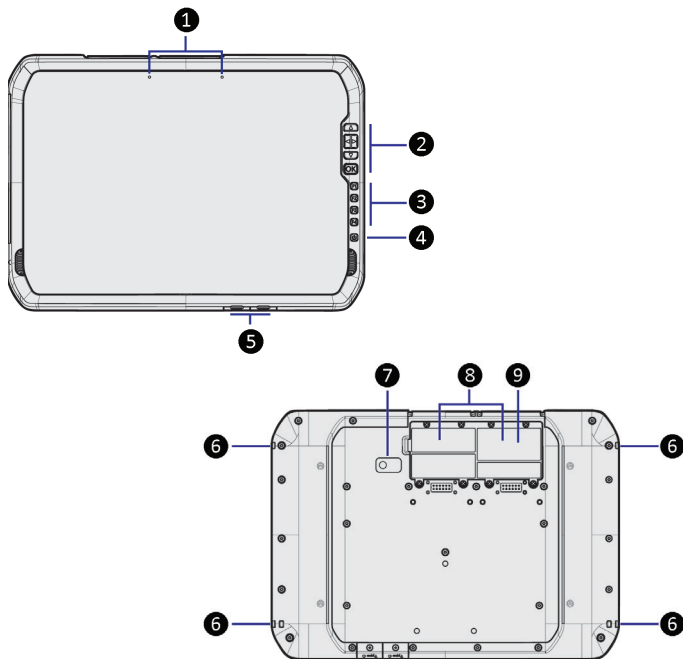

- | | |
|-------------------------------|---|
| ❶ Dual microphones | ❹ Stylus tether loops (x4) |
| ❷ Directional pad & OK button | ❺ Camera and LED flash |
| ❸ Function keys (x4) | ❻ Trimble EMPOWER module bays (x2) |
| ❹ Power button | ❼ MicroSIM & MicroSD card slots
(Remove door to access card slots) |
| ❺ USB C-Type ports (x2) | |

INSTALL MICROSIM CARD / MICROSD CARD (OPTIONAL)

Remove door to access
MicroSIM card and MicroSD
card slots.

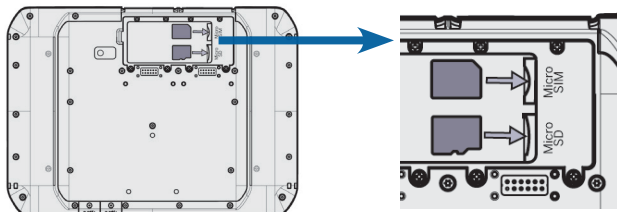

TETHER THE STYLUS, STORE IN THE STYLUS HOLDER

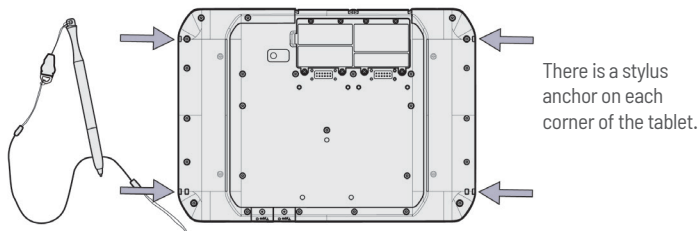

INSTALL THE SCREEN PROTECTOR

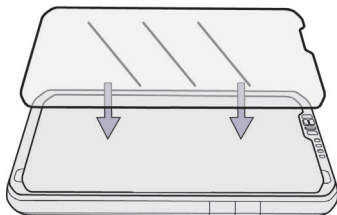

FULLY CHARGE THE BATTERY FOR 4 HOURS

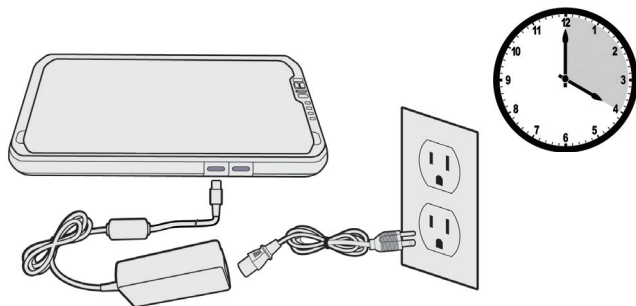

TURN ON AND SET UP THE ST100 TABLET

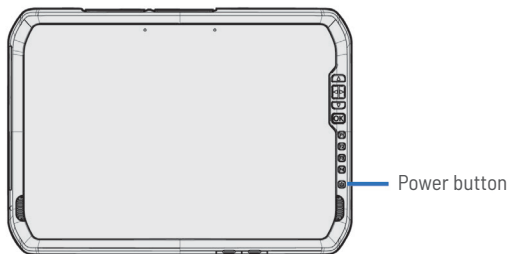

© 2022, Trimble Inc. All rights reserved. Trimble and the Globe & Triangle logo are trademarks of Trimble, registered in the United States and in other countries. Spectra Geospatial is a Division of Trimble Inc. Spectra Geospatial and the Spectra Geospatial logo are trademarks of Trimble Inc. or its subsidiaries. All other trademarks are the property of their respective owners. Revision B. P/N 124159-ENG (04/22).

